

CODE/ALARM  
**SURESTART<sup>LX</sup>**

---

*Remote Security and  
Convenience System*

# *Owner's Manual*

**IMPORTANT NOTE:** The operation of the SURESTART as described in this manual is applicable to most vehicles. However, due to the engine type and configuration of some vehicles (i.e. diesel engines), some functions AND/OR SAFETY PRECAUTIONS may not apply. Please see your installing dealer for more information.

## **Table of Contents**

---

<b>Features and Benefits of the SureStart™ LX</b> .....	<b>3</b>
<b>Using Your Remote Transmitter</b> .....	<b>4</b>
Arming the Security System	
<i>Pre-arm Mode</i>	
Disarming the Security System	
<i>Attempted Intrusion Identification</i>	
Disabling the IR-s™ Impact Sensor .....	<b>5</b>
Two-Stage Door Unlock	
Activating the Trunk Release Feature	
Turning on the Vehicle Headlights	
Using the Car Finder Feature	
Personal Protection Alarm (Panic)	
Remote Start / Stop Feature	
Using Valet Mode	
<b>Using Your Remote Starter</b> .....	<b>6</b>
Starting Your Vehicle	
<i>If your vehicle stalls or does not start</i>	
Remote Start Safety Features	
Entering the Vehicle While it is Running via Remote Start	
Pre-Heating or Pre-Cooling the Interior of the Vehicle	
Turning on the Rear-Window Defroster	
Using the “Quick-stop” feature	
<b>When Your Security System is Triggered</b> .....	<b>7</b>
<b>Automatic Convenience Options</b> .....	<b>7</b>
<b>The Interior Status Indicator</b> .....	<b>8</b>
<b>System Maintenance</b> .....	<b>8</b>
Changing the Remote Control Battery	
Adding Remote Controls to Your System	
Deleting Lost or Stolen Remote Controls from Your System .....	<b>9</b>
Programming Selectable Options	
<i>Options Chart</i> .....	<b>10</b>
Programming the Tach Signal .....	<b>11</b>
<b>Basic Troubleshooting</b> .....	<b>11</b>
<b>Emergency Disarm Procedure</b> .....	<b>12</b>

### **Two Easy-to-Use Weather-Resistant Remote Controls**

The remote controls included with the SureStart™ LX utilize durable, moisture resistant cases and sealed rubber buttons for reliability and long life. Rolling code technology prevents the transmitter signals from being duplicated. The button functions are clearly labeled to make the SureStart™ LX simple to operate.

### **All entrances protected**

Opening any door or entrance protected by the security system triggers the alarm's 125db siren (or vehicle horn) and flashes the vehicle parking lights.

### **Starter Disable**

The SureStart™ LX protects your vehicle from theft by disabling the starter when the system is armed.

### **IR-s™ Impact Sensor**

This patented sensor uses infra-red technology to reliably detect vehicle impact associated with attempted intrusion. The IR-s guards against vehicle body damage, and theft car equipment (such as airbags) and personal belongings.

### **Remote Keyless Entry**

The SureStart™ LX conveniently locks and unlocks vehicle doors and opens the trunk or hatch by remote control.\*

### **Personal Protection Features**

Remote Panic Alarm, Headlight control, Illuminated Entry, and Car Finder are among an array of features that enhance personal safety.\*\*

### **Interior Status Indicator**

The bright-red warning light is an effective visual deterrent to a would-be thief.

### **Remote Start**

The SureStart™ LX allows you to warm up your vehicle and preheat or pre-cool the interior with the press of a button on the remote control.

### **MaxRange™ Antenna**

This long-range antenna allows you to operate the SureStart™ LX from distances of up to 500 feet. Remote-start your vehicle from the safety of your home, apartment or office building.

\* If vehicle is equipped with power door locks and they are connected to the alarm system by your installer.

\*\* May require additional connections, components, and/or charges. See your installer for details.

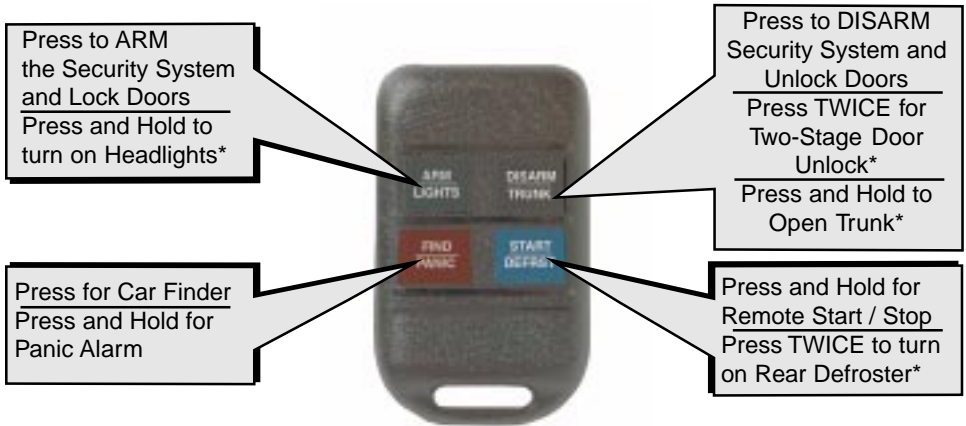

### **Arming the Security System**

To arm the system, exit the vehicle, close all doors, then press\* the ARM button. The siren\*\* will “chirp” twice† and the parking lights will flash twice, indicating the system is armed. The doors will also lock at this time (if equipped and connected). The status indicator (red warning light on the dash) will blink steadily, once per second.

#### **Pre-arm Mode**

If the siren chirps and the parking lights flash only once, this indicates that the vehicle courtesy light is on, or that an entrance is not closed securely. Check to see that doors, hood, and trunk are properly closed. Once all entrances are secured (and the courtesy light is off), the system will chirp / flash again. The system is now fully armed. (If the entrance is not secured within 4 minutes, the system will arm and ignore the unsecured entrance until it is closed.)

### **Disarming the Security System**

To disarm the system, press the DISARM button. The siren will chirp and the parking lights will flash once, and the doors will unlock. The courtesy light will turn on for 1 minute, or until the vehicle is started.

#### **Attempted Intrusion Identification**

If the siren chirps four times when disarming, this indicates that the system was triggered in your absence. The status indicator will also flash rapidly. Perform the following operation to determine the protected zone that triggered the system:

• After disarming, press the emergency override button. The siren will chirp to indicate the cause of the alarm trigger:

<b>1 chirp</b>	Impact Sensor
<b>3 chirps</b>	Door or other Entrance
<b>4 chirps</b>	Ignition was turned on

\* Throughout this manual, ‘press’ refers to pressing for less than 1 second; ‘press and hold’ refers to pressing for more than 1 second.

\*\*Siren’ also refers to the vehicle horn if it is used as the alarm sounding device.

†If you have chosen the Silent Arming Option, the siren will not sound when arming or disarming until the appropriate button is pressed a second time.

### **Disabling the IR-s™ Impact Sensor**

It may be necessary at times to disable the IR-s™ Impact Sensor, especially when parking in areas (like parking garages) where extreme vibration may cause false alarms. Press **both upper buttons** to arm the alarm system and disable the impact sensor. The siren will chirp three times to indicate that the sensor is disabled. The sensor will become enabled again the next time the system is armed normally.

### **Two-Stage Door Unlock**

If this feature is enabled on your system, pressing DISARM one time will unlock only the driver's door. Press DISARM again within 1 minute to unlock all doors.

### **Activating the Trunk Release Feature**

Press and hold TRUNK to open the vehicle trunk or hatch (if equipped and connected). If this button is used to operate another accessory, the accessory will stay active for as long as the button is held.

### **Turning on the Vehicle Headlights**

Press and hold the LIGHTS button to turn on the vehicle headlights. (The alarm system will attempt to arm if not already armed, unless it is in Valet mode.) The lights will stay on for 20 seconds, or until LIGHTS is pressed again.

### **Using the Car Finder Feature**

Press FIND on the remote control to locate your vehicle. The siren will emit five short chirps each time the button is pressed.

### **Personal Protection Alarm (Panic)**

Press and hold the PANIC button to activate the vehicle siren and parking lights for 30 seconds. (If the vehicle horn is connected, the horn will “pulse” for 30 seconds.) Press any remote control button to turn off the Panic alarm.

### **Remote Start / Stop Feature**

Press and hold START on the remote control. If all safety parameters are correct, the engine will start within 5 seconds (diesel engines will take longer.) Press and hold START again to turn off the vehicle. (Turn to page 6 for more on remote start features.)

### **Using Valet Mode**

If the Passive Arming feature is enabled on your system, Valet mode temporarily prevents the alarm system from arming automatically. This is useful when fueling or servicing your vehicle.

#### **To enter valet mode:**

With the vehicle ignition on, press the ARM button. The red dashboard warning light (status indicator) will turn on for one second, then turn off. This indicates that the system is in Valet mode. Once the ignition is turned off, the status indicator will emit a quick double-flash pattern.

**Note:** In Valet mode, all keyless entry, convenience and remote start features operate normally.

#### **To exit Valet mode:**

With the vehicle ignition on, press the DISARM button. The red dashboard warning light (status indicator) will turn on for one second, then turn off. This indicates that the system has exited Valet mode.

**Hint:** To prevent your security system from automatically arming while unloading or refueling your vehicle, without placing the system in valet mode, simply press the disarm button on your remote control transmitter after turning the ignition key off. Doing so places your system into a temporary or onetime valet mode. Next time you exit your vehicle the system will arm normally.

### **Starting Your Vehicle**

The remote start function is activated by pressing and holding START on the remote control. The system will check the vehicle to ensure that it is safe to start, and if all safety parameters are correct, the engine will start within 5 seconds (diesel engines will take longer.) Press and hold START again to turn off the vehicle.

#### ***If your vehicle stalls or does not start...***

If the vehicle stalls or does not start, the SureStart™ LX will pause 5 seconds, then try 3 more times to start the vehicle (a total of four attempts). The system pauses 5 seconds between each start attempt. If the vehicle does not start after the fourth attempt, the SureStart™ LX will abort the start process.

Your vehicle can be started by remote control whether the alarm is armed or disarmed. When the alarm is armed, the impact sensor turns off when the vehicle is started to prevent the engine vibration from setting off the alarm.

### **Remote Start Safety Features**

For safety and security reasons, the SureStart™ LX will shut off the vehicle during remote start if any of the following occur:

- The vehicle hood is opened
- The brake is pressed before the vehicle ignition is turned on with the key
- The engine reaches 3 times its normal idle\*
- The alarm is triggered

As a safety precaution, the vehicle will shut off if left unattended for 15 or 24 minutes, depending on the time preset by your installer.

### **Entering the Vehicle While it is Running via Remote Start**

1. Press DISARM to unlock the door(s) and turn off the alarm system (if it is not already off).
2. Enter the vehicle. Do not press the brake pedal.
3. Insert the key into the ignition and turn to the ON position.
4. Press the brake pedal. The remote starter disengages and the vehicle will operate normally.

### **Pre-Heating or Pre-Cooling the Interior of the Vehicle**

Before exiting the vehicle, set the temperature controls to the desired setting and operation. After the SureStart™ LX starts the vehicle, the heater or air-conditioning will activate and heat or cool the interior to your setting.

### **Turning on the Rear-Window Defroster (if connected)**

While the vehicle is running via remote start, press DEFROST on the remote control. The vehicle defroster will activate and run for 10 minutes, or for your vehicle's preset time limit.

### **Using the "Quick-stop" Feature**

If you want to make a short stop and leave your vehicle running (to keep the interior warm or cool, for instance), the quick stop feature allows you to do this while keeping your vehicle secure and your keys with you.

\*May not apply to all vehicles. See your installer for details.

### **To engage quick stop:**

1. Stop the vehicle and place the transmission in PARK.
2. With your foot off the brake pedal, press START on the remote control. The parking lights will turn on, indicating that the vehicle is now running via remote start.
3. Remove the keys from the ignition and exit the vehicle. Press ARM to arm the alarm system if desired.

**Note:** Do not leave children or animals unattended in the vehicle when using the quick stop feature.

## **Automatic Convenience Options**

---

The SureStart™ LX performs a variety of automatic functions to enhance security and comfort. Some of these features are programmable at the time of installation. Please see your installer for further details.

### **Illuminated Entry**

When the alarm system is disarmed, the vehicle courtesy lights will turn on for 1 minute, or until the vehicle is started or the system is re-armed.

### **Illuminated Exit**

When removing the key from the ignition, the vehicle courtesy lights will turn on for 1 minute, or until the SureStart™ LX is armed.

### **Automatic Arming**

The SureStart™ LX will arm automatically 1 minute after the key is removed from the ignition. This feature can be temporarily disabled by placing the system into Valet mode.

### **Ignition Lock**

If all doors are closed and the vehicle is started with the key, the doors will automatically lock.

### **Ignition Unlock**

When removing the key from the ignition, the doors will automatically unlock.

## **When Your Security System is Triggered**

---

The SureStart™ LX will trigger if one of the following events occurs while the system is armed:

- Any protected entrance is opened
- The vehicle ignition is turned on
- The vehicle is jolted hard enough to signal the impact detector

Once the alarm is triggered, the siren (or horn) sounds and the vehicle parking lights flash for 30 seconds. The system will then re-arm, awaiting the next intrusion attempt.

## 8 **The Interior Status Indicator**

The Status Indicator is a high-intensity red light mounted in a visible location on the vehicle dashboard. This red light gives a visual indication of the alarm system's state of operation. Note the chart below:

<b>If the Status Indicator is...</b>	<b>....then the Security System</b>
Off	is disarmed
Flashing Slowly (about once)	is armed
Flashing Very Quickly	was triggered in your absence (see Attempted Intrusion ID - page 4)
Flashing Intermittently (2 flashes, off, 2 flashes)	is in Valet mode
On (not flashing)	is in Pre-arm mode

## **System Maintenance**

### **Changing the Remote Control Battery**

The 12-volt alkaline battery supplied in your remote control should last approximately one year, depending on usage. When the battery begins to weaken, you will notice a decrease in range, or the distance from your vehicle that your remote transmitter will operate. Follow the instructions below to change the remote transmitter battery.

1. Insert the edge of a coin into the slot at the top of the remote control. Twist the coin to pry the remote control halves apart.
2. Remove the old battery and replace with a new one. Be sure to observe the (+) and (-) signs in the battery compartment.
3. Carefully snap the case halves back together, then test the remote control. **It is not necessary to re-program the remote control after changing the battery.**

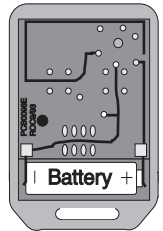

### **Adding Remote Controls to Your System**

The SureStart™ LX has the ability to operate from up to four (4) remote controls. Follow these instructions to add a remote control to your system.

1. Make sure the security system is disarmed and the ignition is off.
2. Open the driver's door.
3. Turn vehicle ignition on.
4. Press and hold emergency override button.  
*After 15 seconds, the siren or horn will sound three (3) times. This indicates that the unit has entered the remote control programming mode.*
5. Release the button.
6. Press the ARM button (button 1) on the remote control to be programmed.  
*The siren or horn will sound once, indicating that the system has "learned" that remote control.*
7. Repeat step 6 for any additional remote controls.
8. Turn the vehicle ignition off to exit the programming mode. Test all remote controls to ensure that they work properly.



## Deleting Lost or Stolen Remote Controls from Your System

If one of your remote controls is lost or stolen, follow these instructions **IMMEDIATELY** to remove the control code from your system.

1. Make sure that you have all remaining remote controls available.
2. Enter the control programming mode by following steps 1 - 5 of **Adding Remote Controls to Your System** (page 8).
- 3a. **If you have only one remaining remote control**, press the ARM button on that remote control **four (4) times**, pausing at least 1 second in between each press. Make sure that the siren chirps each time you press the ARM button.
- 3b. **If you have two remaining remote controls**, press the ARM button on each remote control **two (2) times**, pausing at least 1 second in between each press. Make sure that the siren chirps each time you press the ARM button.
- 3c. **If you have three remaining remote controls**, press the ARM button on the first remote control **two (2) times**, then press the ARM button on the other two remote controls **once**. Pause at least 1 second in between each press. Make sure that the siren chirps each time you press the ARM button.
4. Turn the vehicle ignition off to exit the programming mode. When you are finished, the lost or stolen remote control will no longer operate your system.

## Programming Selectable Options

This section explains the process for changing certain operating characteristics of the SureStart™ LX. These options were set by your installer at the time of installation. These options should not need to be changed once installation is complete. Please exercise **extreme caution** as some of these options configure the SureStart™ LX to interface with your specific vehicle. Changing these options may result in faulty operation or vehicle damage. **See your installer for details.**

**Note: Remote controls must be programmed prior to these steps.**

1. Repeat steps 1-5 of **Adding Remote Controls to Your System** (page 8).
2. Press and release the emergency override button.  
*The horn or siren will sound four (4) times. This indicates that the unit has entered the **Security Options Programming** mode.*
2. Press the ARM button (button 1) on a programmed remote control to begin option selections. The siren or horn will sound a number of times to indicate the number of the option.
3. Press the DISARM button (button 2) to turn the option on or off. The vehicle red status indicator on the dashboard indicates whether an option is on or off.
  - **If the selected option is ON, the indicator will light.**
  - **If the selected option is OFF, the indicator will turn off.**
  - **The status indicator will turn on or off when an option is changed.**
4. When changes are complete, press and release the emergency override button to continue to the **Remote Start Options Programming** mode. (Siren or horn will sound five (5) times.) Turn the vehicle ignition off to exit programming.  
**See Options Chart on next page.**

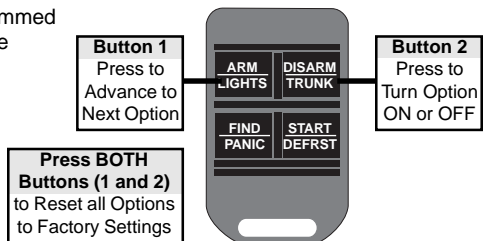

**Options Chart**

OPTION	DESCRIPTION	Default settings in <b>BOLD</b> STATUS INDICATOR	
<b>Security Options Programming</b>			
1. Extended Locks	Lock duration is (1) 5 sec. or (2) 0.6 sec	ON(1)	<b>OFF(2)</b>
2. Lock with Ignition	Doors lock when all doors are closed and ignition turned on	<b>ON</b>	OFF
3. Unlock with Ignition	Doors unlock when ignition is turned off	<b>ON</b>	OFF
4. Illuminated Exit	Courtesy light turns on for 60 sec. after ignition is turned off	<b>ON</b>	OFF
5. Passive Arming	Alarm automatically arms 60 sec. after ignition is turned off	<b>ON</b>	OFF
6. Siren / Horn Chirps	(1) by pressing ARM or DISARM twice (manual) (2) by pressing ARM or DISARM once (auto)	ON(1)	<b>OFF(2)</b>
7. Noise Control	Alarm will (1) sound for five 30 sec. cycles then ignore trigger, or (2) sound continuously when triggered if entrance is left open	ON(1)	<b>OFF(2)</b>
8. Siren / Horn Output	Siren / horn output (1) is continuous when alarm is triggered, or (2) pulses when alarm is triggered	<b>ON(1)</b>	OFF(2)

**Remote Start Options Programming**

1. Diesel Mode	ignition turns on Output is (1) Heater/AC or (2) Ignition	ON(1)	<b>OFF(2)</b>
2. Optional Htr/AC or Ignition Output	Run time is (1) 24 min. or (2) 15 min.	ON(1)	<b>OFF(2)</b>
3. Run Time	<b>4 5</b>	ON(1)	<b>OFF(2)</b>

**4 and 5. Start Operation**

Tach Sense Mode	ON	OFF	<b>Option 4:</b> ON(1) OFF(2) <b>Option 5:</b> ON(1) OFF(2)
Voltage Sense	OFF	ON	
No Tach Mode	OFF	OFF	

6. Unused	DO NOT CHANGE SETTING		
7. Headlight / Aux. 1 Function	Output is (1) 20 seconds latching or (2) pulse	<b>ON(1)</b>	OFF(2)
8. Defrost / Aux. 2 Function	Output is (1) 10 min, latching during remote start or (2) pulse	ON(1)	<b>OFF(2)</b>

**Note:** If the system is in Valet mode, it will exit Valet mode when programming is complete.

## Programming the Tach Signal

**Note:** This procedure was completed at the time of installation, and should not need to be repeated. This should only be performed by an authorized installer. If you feel that your system may not be operating correctly, see your installer. Improper programming may cause vehicle damage.

1. Open the vehicle hood. (Hood pin switch must be installed to program tach.)
2. Press and hold the brake pedal. Turn the ignition on and off slowly **two (2) times**, then release the brake pedal.

*If done correctly, the siren or horn will sound two (2) times. This indicates that the unit has entered the tach programming mode.*

3. After entering the program mode, start the vehicle without pressing the brake pedal. The unit will respond by flashing the parking lights once as soon as the vehicle has started. This indicates that it has learned the start speed.
4. Allow the engine to come to a normal idle (5-10 seconds). The unit will flash the parking lights every five (5) seconds to indicate that it has learned the current idle speed.
5. Press and release the brake pedal to exit the programming mode. Turn the engine off.

## Basic Troubleshooting

This section outlines some of the basic issues you may experience while becoming used to the SureStart LX. If you have a problem that is not covered by this section, please consult your installer.

Symptom	Problem	Solution
Remote control doesn't work	<ul style="list-style-type: none"><li>• Weak or dead battery</li><li>• Remote control not programmed</li></ul>	<ul style="list-style-type: none"><li>• Change battery (page 8)</li><li>• Program remote control (page 8)</li></ul>
System will not arm	<ul style="list-style-type: none"><li>• Door or other entrance is open</li><li>• Courtesy light is on</li><li>• System is in Valet mode</li></ul>	<ul style="list-style-type: none"><li>• Close entrance</li><li>• Turn courtesy light off</li><li>• Turn off Valet mode (page 5)</li></ul>
System will not start	<ul style="list-style-type: none"><li>• Hood is open</li><li>• Brake is pressed</li></ul>	<ul style="list-style-type: none"><li>• Close hood</li><li>• Release brake</li></ul>

## Emergency Disarm Procedure

If your remote control is lost or fails to function, use this procedure to disarm the SureStart™ LX and start your vehicle.

1. Use the keys to enter the vehicle. The alarm will sound once the door is opened.
2. Insert the key into the ignition and turn to the ON position.
3. Locate and press the emergency override button. The alarm will turn off and the you will be able to start your vehicle.

## Security

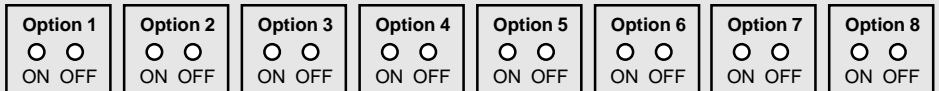

## Remote Start

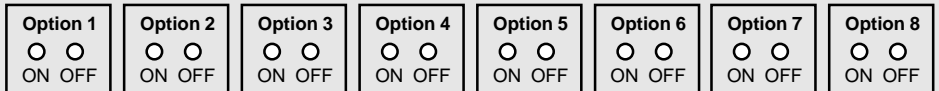

This device complies with part 15 of the FCC rules and with RSS-210 of the industry Canada. Operation is subject to the following two conditions: (1) this device may not cause harmful interference, and (2) this device must accept any interference received, including interference that may cause undesired operation.